

Kentville West Wellfield Land Use Zoning

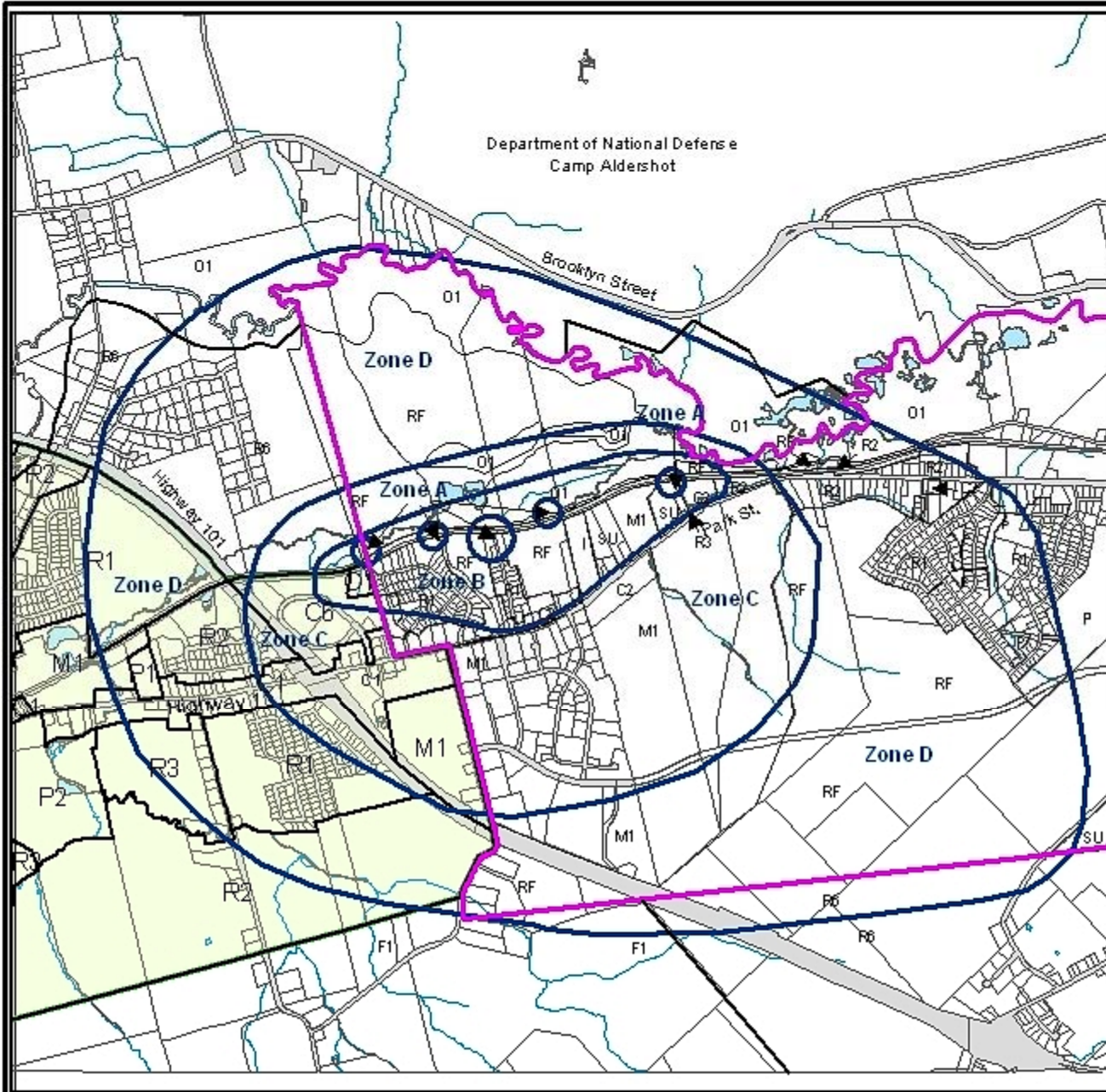

Legend

- Town of Kentville Limits
- Growth Centre Boundary
- Roadways
- Property Boundaries
- Water Bodies
- Protection Zones

Kentville Zoning

- Residential
- Residential
- Residential
- Residential Future
- Industrial
- Parkland
- Institutional
- Commercial
- Open Space
- Special Use

Coldbrook Zoning

- Residential Single Dwelling
- Residential One and Two Unit
- Residential Mixed Density
- Light Industrial Commercial
- Parkland
- General Commercial
- Commercial Comprehensive Development
- Environmental Open Space

Rural County Zoning

- Country Residential
- Forestry
- Environmental Open Space

**Planning
Development
SITE Project Management**

Topographic Data and Property Data:
Service Nova Scotia and Municipal Relations
Nova Scotia Geomatics Service Centre
Amherst, 2003 via Mun. of the County of Kings
and the Town of Kentville

Town Data: Town of Kentville

County Data: Mun. of the County of Kings

Protection Zone c:
From Hill and Seamore S.W.G. Shaw, 2002

Prepared By: The 4Site Group, November 2003

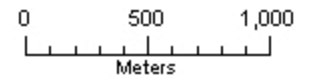

This map is a graphical representation
of property boundaries. It is not intended
to be used to calculate exact dimensions.